



OBX 65

Tilt Mount Installation Manual





Included in the tilt mount kit:

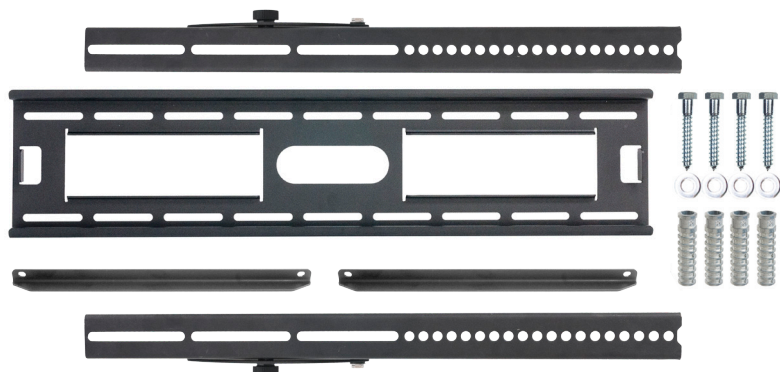

2- Mounting Arms

1- Mounting Plate

2- Locking Bars

4- 5/16"x 2 1/2" Lag Screws

4- 5/16" Lag Shields

4- 5/16" Flat Washers

Tools Required for Installation:



Ratchet with 1/2" Socket



Drill with 1/2" Masonry Bit or
3/16" Wood Bit

Warning: Do not plug speaker bar into A/C outlet until connections to the television have been plugged in. This will severely damage the speaker bar if not followed completely.



Lay blanket down on flat sturdy surface. Run hand over surface to make sure there are no sharp object or protrusions, when the television is laying down.

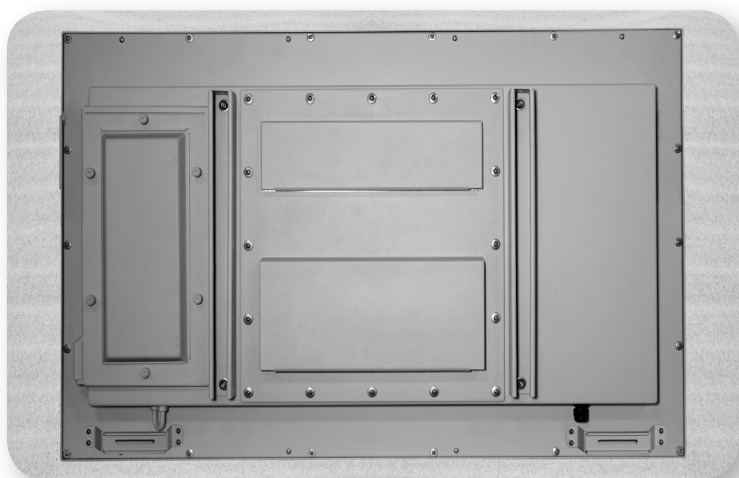

Lay television down, viewing side down on blanket.

Gather the **4** clamping nuts with springs. **These will be in a separate bag shipped with the User Manual Packet.**



1: Remove the hex head screws and washers. Set the screws and washers in a secure location.

2: Insert spring nuts as shown in picture (2 per power strut). Spring should be touching both sides of the power strut as shown.



3: Align holes of the mounting arms with the holes of the clamp nut springs. The arms should be level with each other. Insert the hex head screws and washers from the first step and secure tightly as shown in the example to the right and below.



Align Holes

Secure Bolts

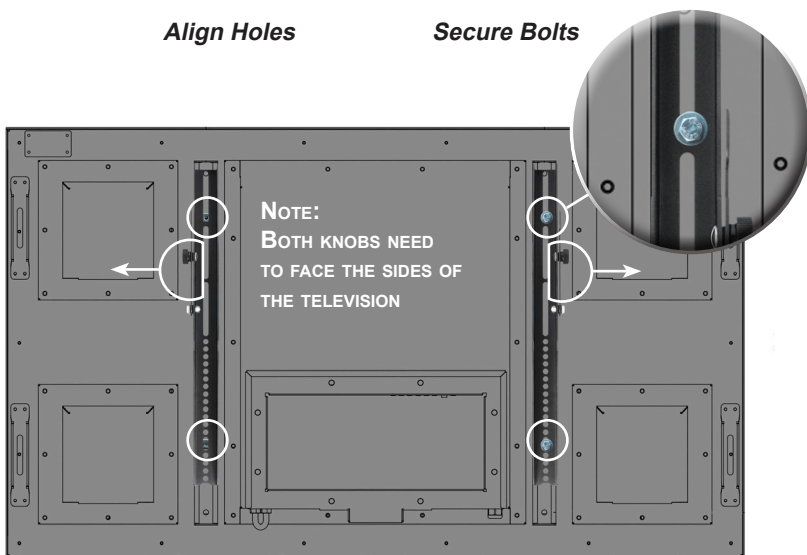

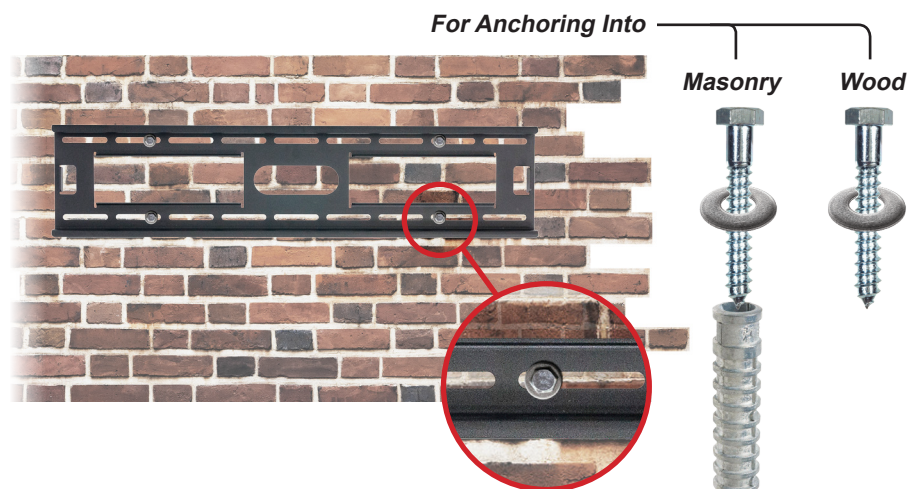

For Masonry:

Set height, level, and mark drill locations on wall. With masonry bit, drill 1/2" pilot holes and hammer in lag bolt shields. Hold the plate to the wall. Make sure the plate is level. Using the 4 supplied lag bolts and washers secure plate to the wall.

For Wood:

Set height, level, and mark drill locations on wall.

IMPORTANT: Make sure that drill marks are located where bolts will get secured in a stud or a substantial wood structure.

With wood bit, drill 3/16" pilot hole. Hold the plate to the wall. Make sure the plate is level. Using the 4 supplied lag bolts and washers secure plate to the wall.



With the help from a friend, lift the television and attach the hooks on the mounting arms to the plate on the tilt mount. Tighten knobs on arms once the tilt is set correctly for the television.

Insert locking bars and secure by fastening with a pad lock for added security.



Congratulations you have successfully installed your tilt mount. If you have any questions feel free to contact our technical support team
(877) 475-9883 option 2

